

# 50MM STANDARD FLOOR JOINT COVERS

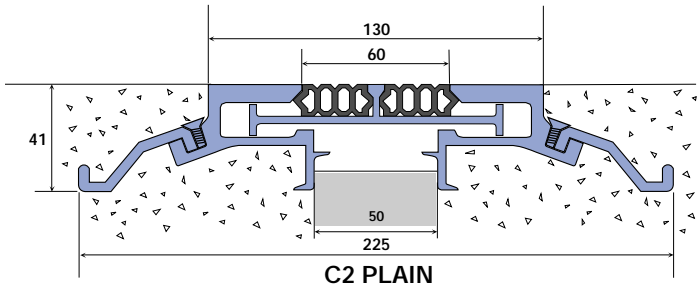

C2 PLAIN

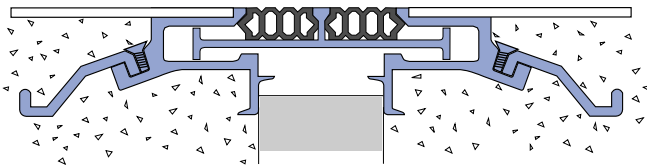

T2 RECESSED

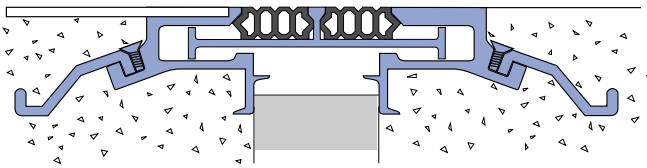

CT2 PLAIN RECESSED

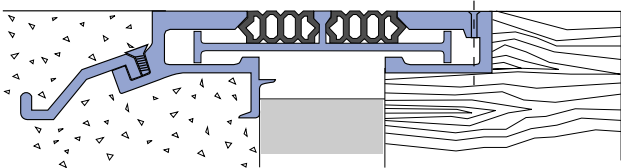

CW2 PLAIN CONCRETE-WOOD  
CTW2 PLAIN CONCRETE-RECESSED  
WOOD ONLY (not illustrated)

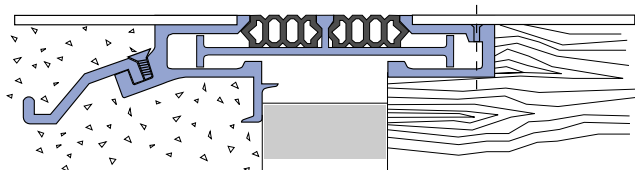

TW2 RECESSED CONCRETE-WOOD  
TCW2 RECESSED CONCRETE-PLAIN  
WOOD ONLY (not illustrated)

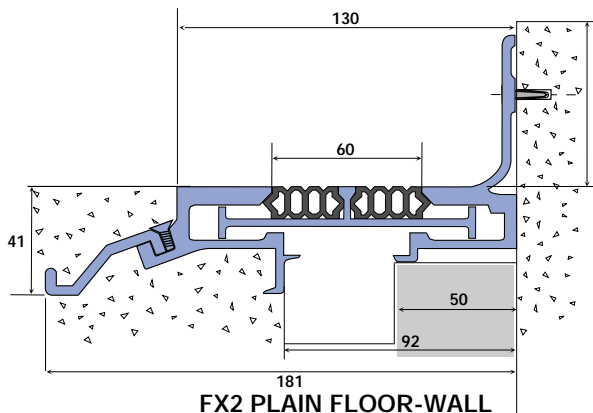

FX2 PLAIN FLOOR-WALL

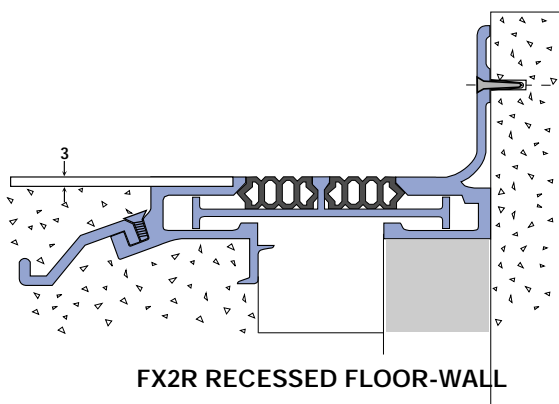

FX2R RECESSED FLOOR-WALL

## Advantages

6 way motion, 50mm horizontal movement, 12.5mm vertical movement, floating I beam design, pre-compressed vinyl filler, no exposed fasteners, factory jiggered, preassembled component, quick set installation.

## Specifications

Furnish and install, as indicated on drawings AMG 6-way extruded aluminum floor expansion joint cover Model No. .... as manufactured by AMG.

Covers shall provide unrestricted 6 way movement. All components shall be factory jiggered, and shipped to the site preassembled with vinyl filler compressed 50%. Anchors shall be located on 600mm centres. Aluminum extrusions shall be alloy AA-6063-T6C furnished with a mill finish. All surfaces in contact with concrete shall be given one shop coat of zinc chromate primer.